

# 43 Teeth Plastic Sprocket RAD Industrial

with Adaptor Plate mounted onto Gliderol/Steel-Line Drum

## Installation Steps

1. Position Door for clear access to the end of the axle and drum.
2. Fit Retaining Collar Assy and tighten set screw (prevents end float).
3. Mount adaptor plate assy and tighten up M10x1.5x40 bolts with washers, spring washers and nuts.
4. Fit 43T plastic sprocket and check alignment.
5. Pack with washers and a nut as necessary (to align Sprocket to Axle).
6. Secure 43T Sprocket with washers and nyloc nuts.

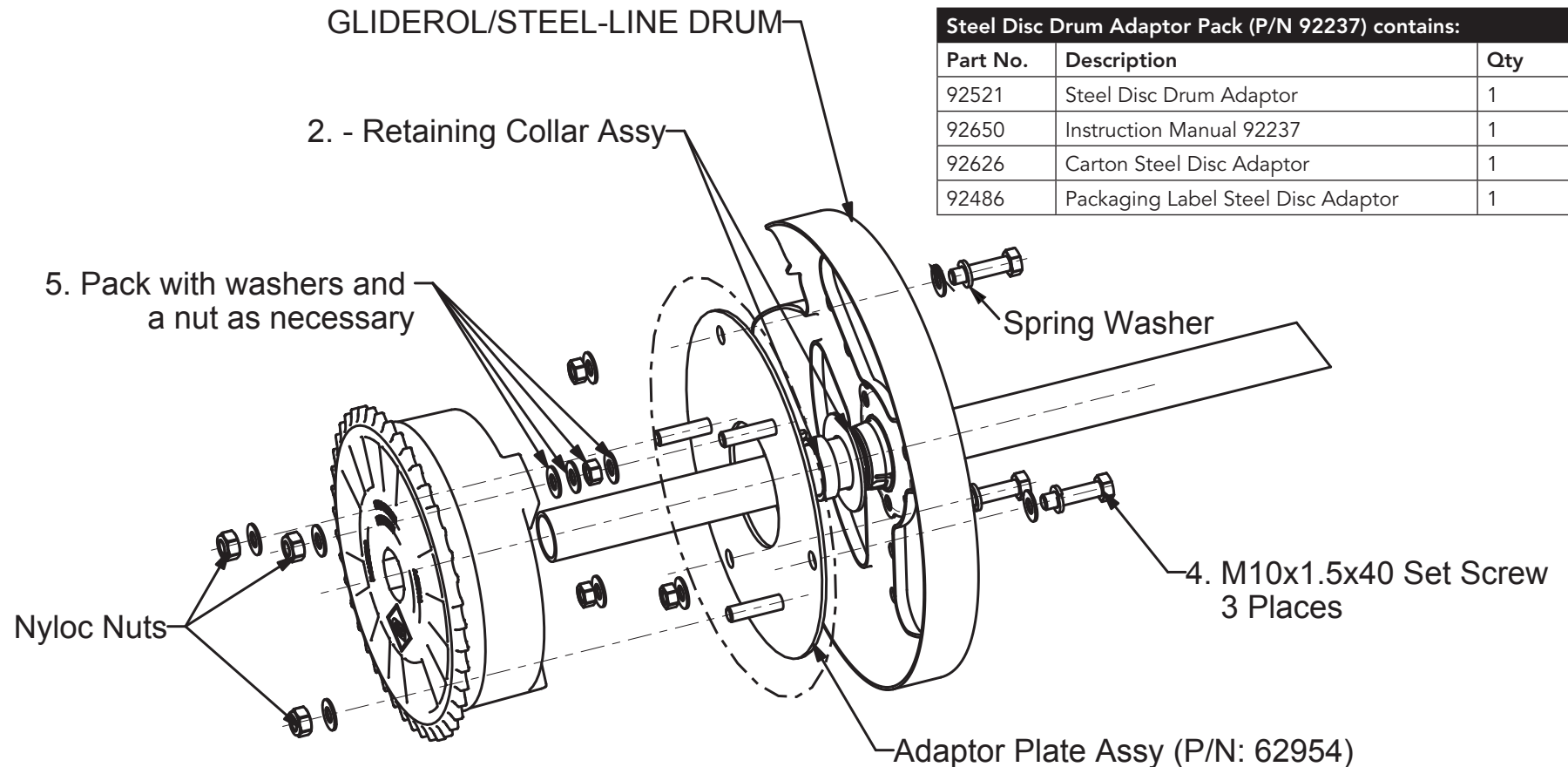

### Steel Disc Drum Adaptor Pack (P/N 92237) contains:

Part No.	Description	Qty
92521	Steel Disc Drum Adaptor	1
92650	Instruction Manual 92237	1
92626	Carton Steel Disc Adaptor	1
92486	Packaging Label Steel Disc Adaptor	1